



HP DESIGNJET

IMPACT

BUSINESS | CLIENTS | COMMUNITY



RPG Squarefoot Solutions

(800) 521-6319

www.rpg.com

info@rpg.com

Making a Major Impact

“ The HP DesignJet Z5600 PostScript® Printer lets us promote that special feeling we aim for in our store. In-store signage inspires our customers to buy the food we sell. ”

*Hans Collin, Store Manager,
ICA Gourmet Shop*



“ The HP DesignJet T830 36-in Multifunction Printer produces high-quality, large-format prints at speed and offers a wide range of extra features. We can easily wheel it around the office and the Android app makes choosing, editing, and printing files so easy—from any location. ”

*Neil Geraghty, Surveyor,
Duke Construction*

Thanks to you, visions are fulfilled and brands are brought to life around the globe. You've helped us become one of the world's best-known names in printing. And now, we're empowering you to take things even further. Discover the impact of HP DesignJet large-format printers.

“ Thanks to this HP DesignJet printer, we are able to print four times faster, reaching an equivalent or even higher quality than in the past, and at a lower printing cost. ”

*Oscar Farrell, Head of Marketing,
Grupo AP Photo*

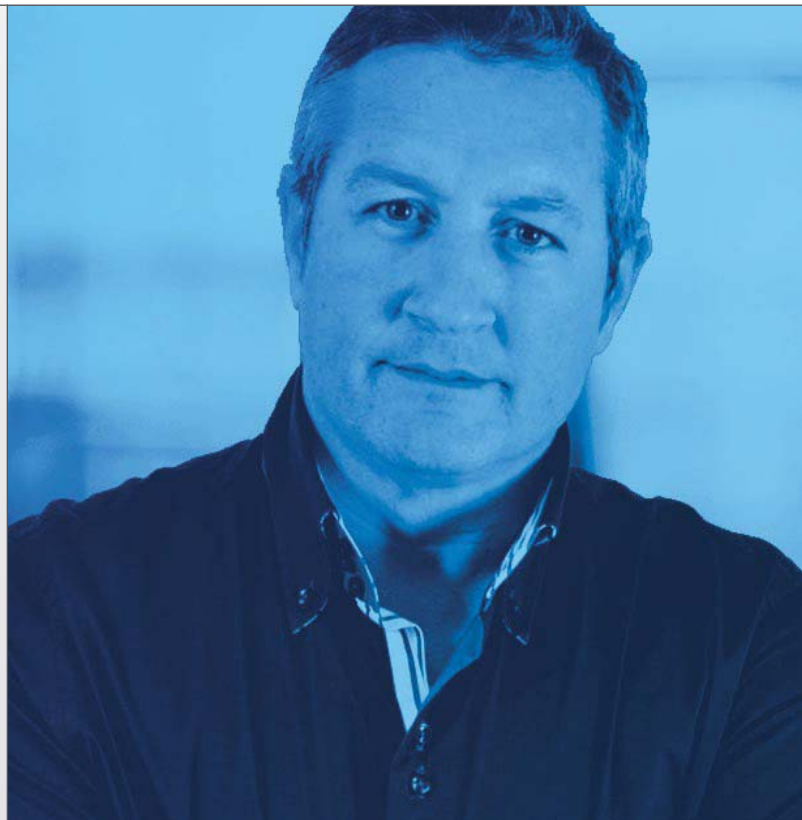

“ One of the biggest benefits of the HP DesignJet Z-series is its embedded spectrophotometer, which monitors color accuracy so we get consistency. ”

*Mark Kadonoff, Owner/CEO,
RPG Square Foot Solutions*

One Portfolio.
Impact for Every Industry.



You and your clients have exacting standards. The HP DesignJet portfolio of printers, as well as our software, inks, and printing materials are designed to meet and exceed them. Both our Z-series and T-series printers deliver the image quality, accuracy, speed, and color necessary to satisfy even the most demanding clients, while keeping costs low and helping you win new and repeat business.



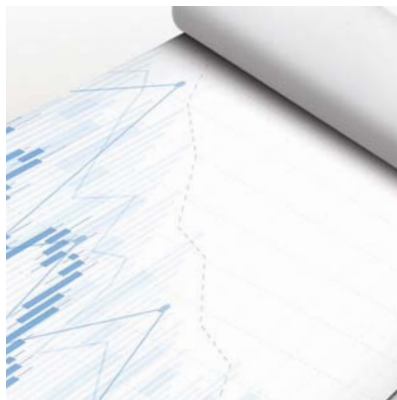

General In-office and Large-format Printing

Take on technical, graphics, or other applications with HP DesignJet printers that provide terrific ease-of-use and flexibility. Print different document types and sizes.



Geographic Information Systems, Exploration, Utilities, and Land Management

Print, copy, and scan drawings, satellite and aerial photos, maps, and more that communicate clearly with excellent image and line quality.

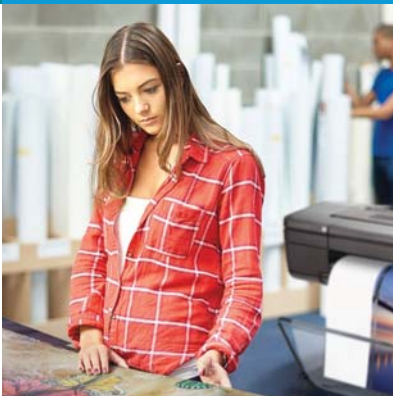

Reprographic and Graphics Print Service Providers

With HP DesignJet, reprographic houses can print, scan, and copy accurate and low-cost monochrome and color plans, plan sets, and renderings. You can quickly print posters, color proofs, POP displays, event signage, and more.

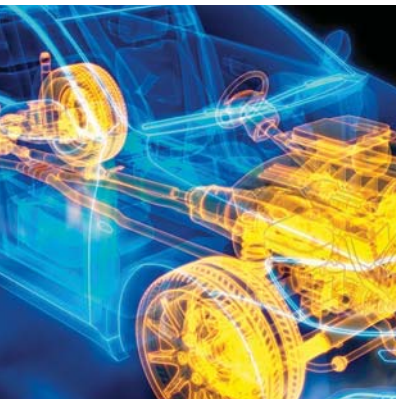

Manufacturing, Automotive, and Transportation

Print big, so even the smallest details get noticed. Produce large-format plans, drawings, renderings, and more—easily, quickly, and with vibrant quality.

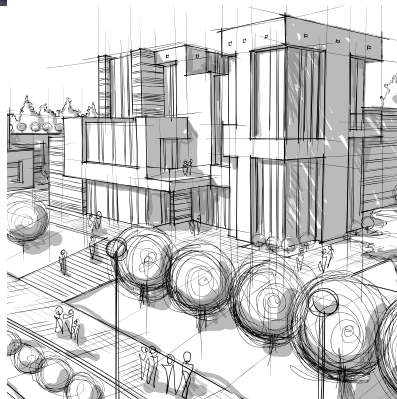

Architecture, Engineering, and Construction

Print large-format drawings, schematics, renderings, and presentations with great ease, speed, and quality. HP DesignJet printers and MFPs can help build and grow your business.



Temporary Retail POP and POS

Tailor your message to customers in stores with information, product displays, and sales offers delivered on demand. For signage with impact, choose large-format HP DesignJet printers.



Education

Encourage learning with large-format signs used for teaching, everyday communications, and more. HP DesignJet printers can help students make the grade.



Digital and Fine Art, and Graphic Design

Show off your digital design with large-format prints and presentations. Produce fine art prints and reproductions that demonstrate strict color accuracy and high quality.



Photography

Bring your vision to life with large-format photographs. HP DesignJet printers enable you to share and promote your work with professional photo quality and accuracy that are true to your vision.



High-quality POP and Exhibition Indoor Signage

Create high-impact signage that lasts with HP DesignJet printers. Show off your brand with large-format prints that demonstrate superb quality along with durability and lasting results — and make a big impression.



Copy Shops and Quick Printers

Print more of the documents your customers want with HP large-format printers that are easy, flexible, fast, and cost effective. Take on a wide variety of jobs and deliver stunning results.

The Impact of Advanced Technology



It's a simple fact: We grow when you grow. We prosper when you do. Our relationship with you is of major importance to us. So we put our heart and soul, our brains, and imagination into developing some of the world's most advanced printing technology. It's another way HP DesignJet large-format printers can help you make the kind of impact that sets your business apart.





High-definition Nozzle Architecture (HDNA) and HP Dual Drop Technology

Provides twice the nozzle density of previous HP DesignJet Z-series printheads. Using dual drop technology, high-definition HP printheads produce a combination of large drop sizes (7 pL) for robust area fills at fast speeds, while small drop sizes (3 pL) reduce visible grain—eliminating the need for light-colored inks.



Adobe PostScript®

Enables you to print any document—text, graphics, images, and color—from any computing platform to any supported device, at the highest quality possible. Delivers optimized quality for PANTONE® color emulation, and eliminates errors, printing complex PDFs with different layers.



Adobe PDF Print Engine

This high-speed, high-fidelity print platform renders PDF job content, converting graphics, text, and images to rasters for driving HP DesignJet large-format printers. It provides tile parallel processing, extended spot color handling, and the smoothest shades ever.



HP Pixel Control

This breakthrough moves from building color output, ink layer by ink layer, to directly choosing color at the pixel level. This results in smoother transitions, richer and deeper colors, accurate spot colors, and sharper details.



HP Embedded Spectrophotometer¹

Integrated with some HP DesignJet printers, this precision instrument provides a high degree of color accuracy and color consistency from the first print to the last one—and from printer to printer—regardless of paper types.



Integrated Vertical Trimmer

The industry's first integrated vertical trimmer, this inline finishing option lets you cut post-processing labor time by up to 20%.²



HP Professional PANTONE® Emulation

Matches colors as closely as possible to the original PANTONE® colors by taking into account your printer and paper type. Designed to produce emulations similar to those set up manually by prepress professionals.



HP Double Swath Technology

Unique to HP, this advanced technology provides breakthrough speed and performance thanks to two sets of printheads, creating a wide print swath and high firing frequency.



HP Optical Media Advance Sensor (OMAS)

Enables you to print at top speeds and still get outstanding results. This breakthrough technology improves paper-advance control and accuracy, so the printer can print at higher speeds across multiple environmental conditions without impairing image quality.



Designed with the Environment in Mind

Most HP DesignJet large-format printers are Energy STAR® certified, which means they meet strict energy efficiency guidelines without sacrificing performance. Most are also EPEAT® registered,³ which means they have a reduced environmental impact across their lifecycle. Learn more at hp.com/sustainability



The Very Latest in Printer Security

HP DesignJet printers have advanced security features built-in to safeguard not only the printers, but your documents and data. We also offer a comprehensive portfolio of proven security solutions, such as HP Secure Boot, whitelisting, self-encrypting hard drives, and more. HP DesignJet printers can not only stop malicious activity, they continually adapt to new threats.

Impactful Solutions, Accessories, and Services

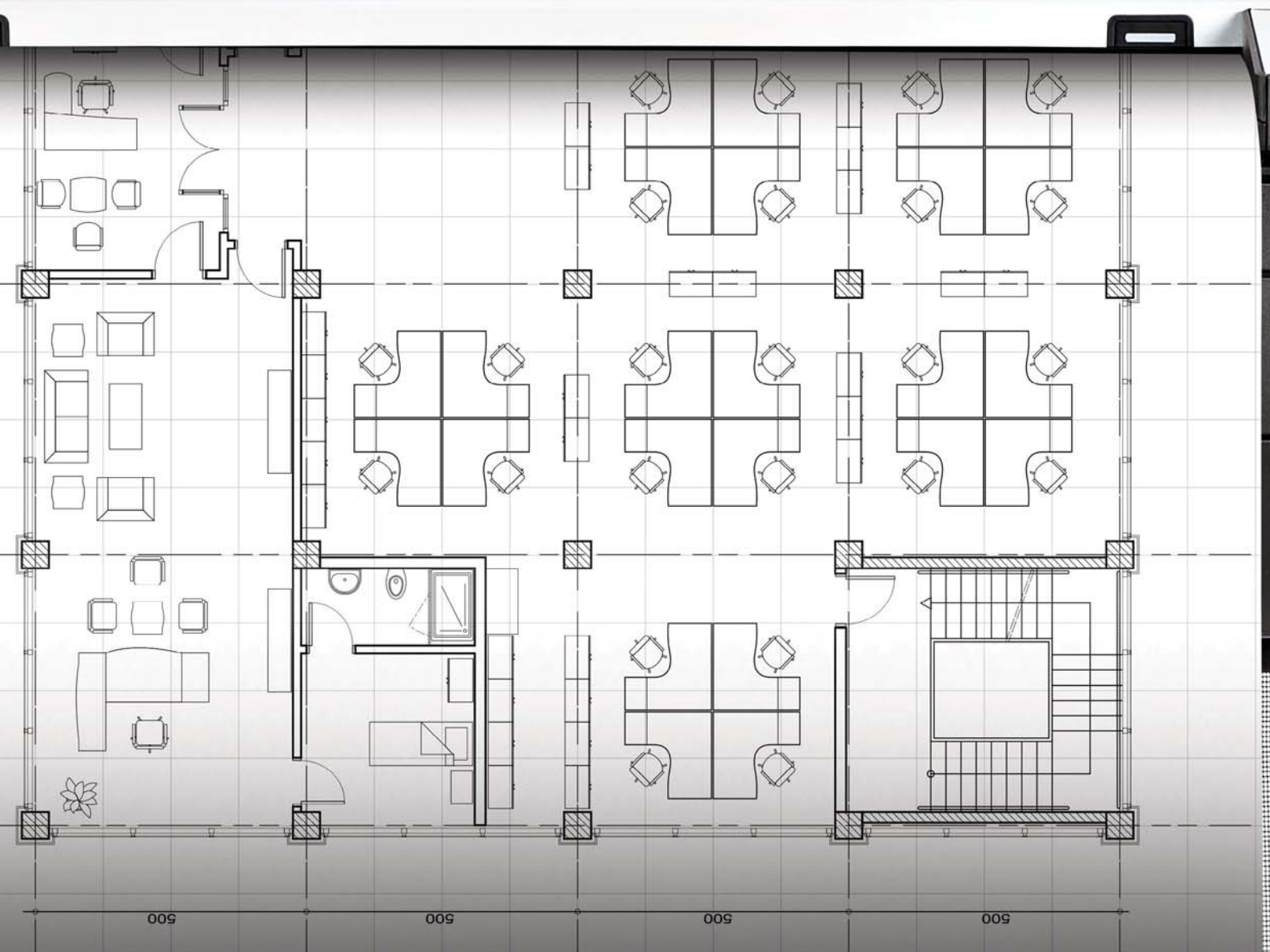

You want to optimize your workflow. This means accomplishing more while saving money, managing your entire fleet (including non-HP large-format printers), and boosting productivity.

We have created advanced software solutions and applications that work with HP DesignJet printers to do exactly what you want.





HP Click Printing Software

With just one click,⁴ print the most common formats from a PC or Mac to HP DesignJet printers. Produce a range of graphics and technical applications. Automatic features optimize media usage and costs. Learn more at hp.com/go/clickdesignjet



HP Web JetAdmin

A web-based print management tool for businesses with more than 15 printers. Lets IT administrators install, configure, monitor, troubleshoot, and manage fleets. Also lets you manage devices, optimize device utilization, and gain visibility with advanced reporting. Learn more at hp.com/go/wja



HP SmartStream

Make large-format production workflow twice as efficient. Takes the challenge out of printing PDFs, expands color production, and brings key efficiencies without changing your current workflow. Learn more at hp.com/go/smartstreamdesignjet



HP Embedded Web Server

Enables you to view printer status information, change settings, and manage the printer at your computer. Provides a simple, easy-to-use solution for one-to-one printer management in environments with a limited number of printers.



HP Mobile Printing

Enables direct printing to local large-format printers from your smartphone or tablet via wireless printing or Wi-Fi Direct. Print remotely by emailing files directly to ePrint-enabled printers.⁵ Also, scan to your mobile device and share documents through email by using the HP Smart App.⁶ Learn more at hp.com/go/designjetmobility



HP Applications Center⁷

A powerful solution for managing your orders with easy content creation and job submission. Bring in new customers with an easy design experience that's also easily integrated into your website. Receive orders 24/7, review your production settings, and prepare a PDF for printing. Learn more at happlicationscenter.com



Third-party Solutions

From printer and fleet management, to additional workflow solutions, HP has partnered with expert third parties to provide a broad choice of comprehensive solutions that integrate seamlessly with existing workflows and deliver the best possible print experience. Learn more at www.hp.com/go/designjet3rdparty



HP PrintOS

This print production operating system with web and mobile apps can help you get more out of your HP printers and simplify your production. Printer owners can access the open, secure, cloud-based PrintOS platform virtually anywhere, anytime to manage jobs from submission to shipment. Learn more at www.hp.com/go/printos



HP DesignJet Universal Print Driver (UPD)

Provide IT teams with greater control and effectiveness, reduce printer-related costs, and improve IT and end-user productivity. This intelligent single-driver solution radically simplifies printer deployment and management, saving time and freeing IT to focus on innovation. Learn more at hp.com/go/designjetupd



Certified RIPs

Our Raster Image Processors (RIP) certification program defines a comprehensive set of compatibility criteria aligned with the highest performance standards and the unique capabilities of HP DesignJet printers. Only third-party companies that have demonstrated conformance with these criteria are awarded HP DesignJet certified status. Learn more at hp.com/go/designjetrips

Original HP Inks

Engineered to work as an optimized system with HP DesignJet printers to provide outstanding results and reliable, trouble-free performance. The result? Less downtime and lower printing costs. Use Original HP Inks to maximize printhead life and ensure full HP warranty protection. Learn more at hp.com/go/originalhpinks

HP Vivid Photo Inks

Formulated to excel on photo, coated, and digital fine art papers, vibrant and durable HP pigment-based inks are designed exclusively for HP DesignJet Z-series printers.

HP Bright Office Inks

Formulated to excel on plain papers, these fast-drying inks are a blend of HP dye-based color inks and HP pigment-based black ink exclusively for use in HP DesignJet T-series printers.



HP Large-format Printing Materials

These materials provide consistently outstanding image quality and, with a wide range to choose from, you'll always find the right printing material for the job, or for almost any application. HP Premium Printing Materials are designed to provide best-in-class performance on key attributes like display permanence. For lower cost options, consider HP Everyday or HP Universal printing materials. Learn more at HPLFMedia.com



HP DesignJet Support Services

Installation Service with Network Setup

Onsite installation and network setup of your HP DesignJet printer by an HP-authorized service technician.

Next Business Day Onsite Repair

Extend your HP warranty for two, three, four, and five years. An HP-authorized service technician typically arrives the next business day. Includes parts, material, and labor.

Post-warranty Services

Provides continued protection after your standard HP warranty or HP Care Pack Service expires. Offered in one- and two-year increments.

Learn more about HP DesignJet Support Services at hp.com/go/designjetsupport



HP DesignJet Z-series



High-impact Quality

Our Z-series printers are perfect for digital print service providers, professional photographers, retail, graphic designers, and geographic information system (GIS) firms—those who expect to create professional photo quality prints with great consistency and precision. To find the right HP DesignJet Z-series printer for you, take a look at the impressive facts and figures on the next page.



Specifications to Help You Choose



HP DesignJet Z9+
PostScript® Printer Series

Printer size/paper size	610 mm (24 inch) 1118 mm (44 inch)
Product description	Professional photo-quality prints, fast and simple
Customer type	Photo labs, photo finishers, designers, print service providers
Ink cartridges	9 inks: C, M, Y, mK, pK, G, CR, CG, CB (GE - optional)
Inks	HP Vivid Photo Inks
Applications	Photos, canvas, backlights, POP graphics/displays, posters, banners, maps, and orthophotos with professional photographic quality
Media handling - input	Two automatic roll feeds and smart roll-switching (on Z9+dr model), roll feed, sheet feed
Media handling - output	Media bin, automatic horizontal cutter (cuts all HP Z-series printer qualified media including most canvas), vertical trimmer (on Z9+dr model), optional take-up reel on 44-in models
Print resolution	Up to 2400 x 1200 optimized dpi
Maximum print speed	24-in model: 56 sqm ² /hr (600 sqft ² /hr) 44-in model: 74 sqm ² /hr (795 sqft ² /hr)
Embedded Adobe PostScript®/PDF	Yes
HP Professional PANTONE® Color Emulation	Yes
HP Click printing software	Yes
Virtual Memory & HDD capacity	Virtual memory: 128 GB (based on 4 GB RAM) Self-encrypted HDD capacity: 500 GB
HP Embedded spectrophotometer	Yes
Ability to print without RIP	Yes
Security	Device Data Document Fleet security management
	HP Secure Boot, whitelisting, signed firmware upgrade, Role Based Access Control, front panel access lock, disable protocols, SNMPv3 IPsec compatibility, TLS/SSL, IPv4 & IPv6 compatibility, CA/JD certificates, 802.1x compatibility, Self-encrypted HDD, secure file and disk erase PIN printing, compatible with the Integrated Célivéo Enterprise Solution for pull-printing HP Web JetAdmin, HP JetAdvantage Security Manager

HP DesignJet Z-series: High-impact Quality



HP DesignJet Z6
PostScript® Printer Series



HP DesignJet Z6810
Production Printer Series



HP DesignJet Z6610
Production Printer

610 mm (24 inch) 1118 mm (44 inch)	1067 mm (42 inch) 1524 mm (60 inch)	1524 mm (60 inch)
High-definition print quality, fast and secure	The fastest high-quality production printing solution ⁹	The fastest graphics production printing solution ⁹
GIS map creators/users, print service providers, and retailers for both graphics and technical applications	Copy shops, print service providers, photo labs, photo finishers, and GIS	Copy shops, print service providers, GIS, retail
6 inks: C, M, Y, mK, pK, CR	8 inks: LC, M, Y, mK, pK, LG, LM, CR	6 inks: C, M, Y, mK, pK, LG
HP Vivid Photo Inks	HP Vivid Photo Inks	HP Vivid Photo Inks
Maps and technical drawings, POP graphics/displays, posters and banners	Posters, banners, mockups, photos, digital fine art, proofs, displays, POP/POS, light boxes – film, exhibition, event graphics	Maps, posters, banners, mockups, photos, digital fine art, banners, exhibition, event graphics, light boxes – film, point of sale/display
Two automatic roll feeds and smart roll-switching (on Z6dr model), roll feed, sheet feed	Roll feed	Roll feed
Media bin, automatic horizontal cutter (cuts all HP Z-series printer qualified media including most canvas), vertical trimmer (on Z6dr model), optional take-up reel on 44-in models	Automatic horizontal cutter, take-up reel (reel not included with 42-in model)	Automatic horizontal cutter, take-up reel
Up to 2400 x 1200 optimized dpi	Up to 2400 x 1200 optimized dpi	Up to 2400 x 1200 optimized dpi
24-in model: 67 sqm ² /hr (720 sqft ² /hr) 44-in model: 85 sqm ² /hr (916 sqft ² /hr)	42-in model: 140 m ² /hr (1500 ft ² /hr) 60-in model: 140 m ² /hr (1500 ft ² /hr)	140 sqm ² /hr (1500 sqft ² /hr)
Yes	Optional	Optional
Yes	Available with PostScript®/PDF upgrade Kit	Available with PostScript®/PDF upgrade Kit
Yes	Yes	Yes
Virtual memory: 128 GB (based on 4 GB RAM) Self-encrypted HDD capacity: 500 GB	Virtual memory: 64 GB (based on 1 GB RAM) HDD capacity: 500 GB	Virtual memory: 64 GB (based on 1 GB RAM) HDD capacity: 500 GB
No	Yes	No
Yes	Yes	Yes
HP Secure Boot, whitelisting, signed firmware upgrade, Role Based Access Control, front panel access lock, disable protocols, SNMPv3	Control Panel Access Lock, disable protocols	Control Panel Access Lock, disable protocols
SNMPv3 compatibility, IPSec compatibility, TLS/SSL, IPv4 & IPv6 compatibility, CA/JD certificates, 802.1x compatibility, Self-encrypted HDD, secure file and disk erase	SNMPv3 compatibility, IPSec, secure disk, file erase, certificates management, and SSL	SNMPv3 compatibility, IPSec, secure disk, file erase, certificates management, and SSL
PIN Printing, compatible with the Integrated Célivéo Enterprise Solution for pull-printing	No	No
HP Web JetAdmin, HP JetAdvantage Security Manager	HP Web JetAdmin, HP JetAdvantage Security Manager	HP Web JetAdmin, HP JetAdvantage Security Manager

HP DesignJet T-series

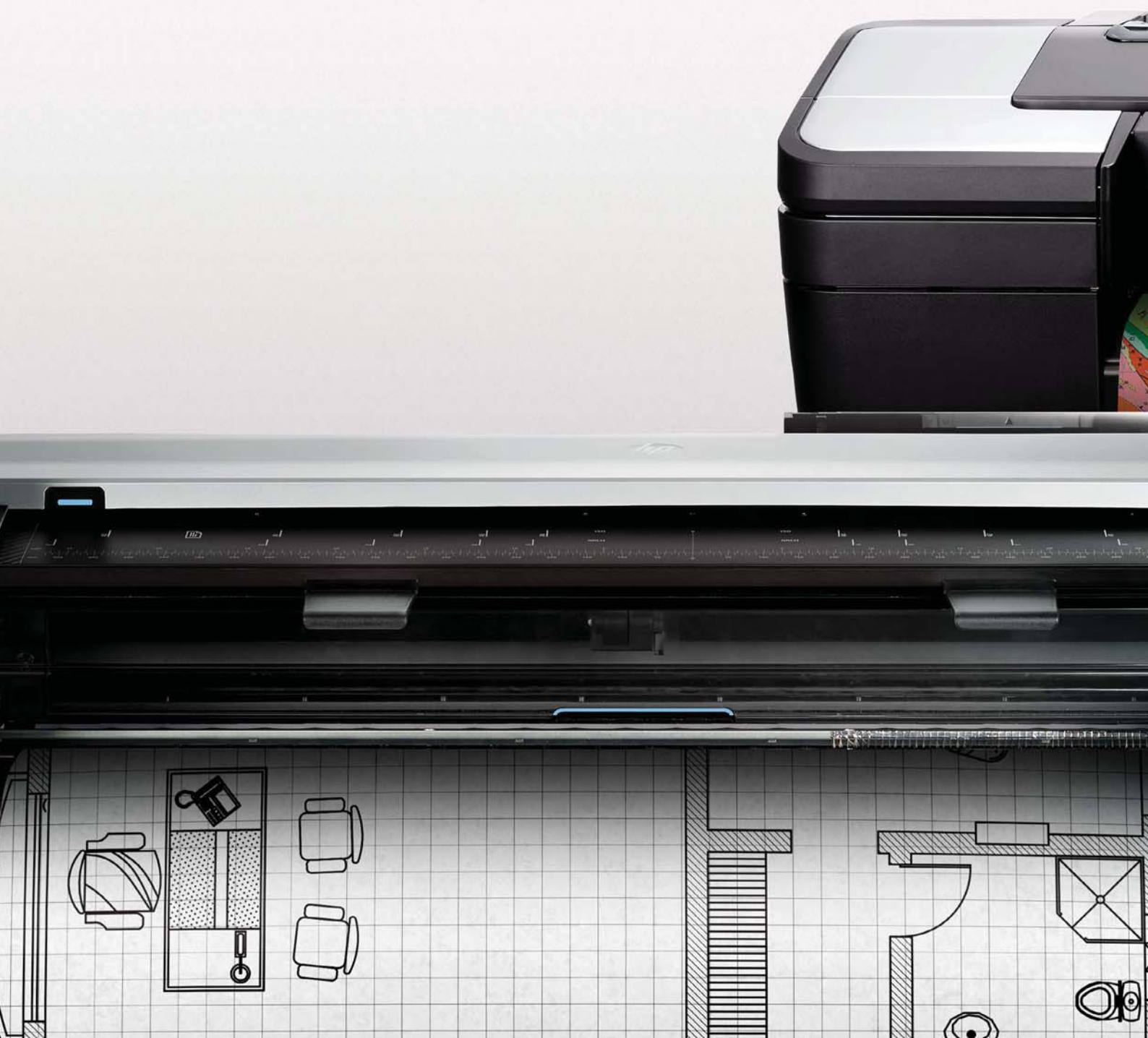

High-impact Accuracy

These printers are ideal for architectural, engineering, and construction companies (AEC) and geographic information system (GIS) firms. Also, MCAD professional users and workgroups and government agencies. If you need to print, scan, or copy maps, technical drawings, or renderings with precise, accurate line quality and crisp text, be sure to review the specifications on the following pages.



Specifications to Help You Choose



HP DesignJet T7200
Production Printer

HP DesignJet T3500
Production Multifunction Printer

		HP DesignJet T7200 Production Printer	HP DesignJet T3500 Production Multifunction Printer
Printer size/paper size		1067 mm (42 inch)/A0+	914 mm (36 inch)/A0
Scan and copy functions		No	Yes
PostScript® version available		Yes (through PostScript® upgrade)	Yes (through PostScript® upgrade)
Print speed (line drawings)		15.5 sec/page on A1, 165 A1 prints/hour	21 sec/page on A1, 120 A1 prints/hour
Scan speed		No	Color: up to 6.35 cm/sec, (2.5 in/sec). Grayscale: up to 19.05 cm/sec (7.5 in/sec)
Print languages (standard)		HP-GL/2, HP-RTL, CALS G4	HP-GL/2, HP-RTL, TIFF, JPEG, CALS G4
Additional print languages PostScript® SKU/ PostScript® upgrade (optional)		Adobe PostScript® 3, Adobe PDF 1.7, TIFF, JPEG	Adobe PostScript® 3; Adobe PDF 1.7
Scan formats (standard)		No	TIFF, JPEG
Additional scan formats PostScript® upgrade (optional)		No	PDF, multipage PDFs
Ink cartridges capacity		775-ml matte black and dark gray, ink cartridges 400-ml (all colors) Original HP Ink cartridges	300-ml Original HP Ink cartridges
Inks		Bright Office Ink	Bright Office Ink
Number of rolls/maximum roll length		Two roll feeds (upgradeable to three); rolls up to 200-m (650-ft) long	Two automatic frontloading roll feeds; rolls up to 200-m (650-ft) long
Compatible media core size		2 and 3 inch	2 and 3 inch
Cut sheet support		No	Yes
Media handling: output, capacity		Integrated media bin, up to 100 A0/E-size capacity, external stacker sold as an accessory, up to 500 A1/D-size capacity	Integrated output stacker, up to 100 A1/D-size capacity and integrated media bin
Memory		64 GB (based on 1 GB RAM), 320 GB hard disk	128 GB (based on 2.5 GB RAM), 500 GB hard disk (AES-256 encrypted, FIPS 140-2 Level 2 certified)
Interfaces (standard)		Gigabit Ethernet (1000Base-T), EIO Jetdirect accessory slot	Gigabit Ethernet (1000Base-T), Hi-Speed USB 2.0 certified host connector
PIN printing		No	Yes
Mobile printing	Email printing	No	Yes
	In-OS printing	No	No
	HP Smart App	No	No
Job accounting functionality		Yes	Yes
Manage print queues		Yes	Yes
HP SmartStream for HP DesignJet printers		Yes	Yes
HP DesignJet Partner Link Alert Service		No	Yes
Security	Device	Disable network ports and protocols, signed firmware upgrade, Front Panel Access Lock	UEFI Secure Boot, disable network ports and protocols, signed firmware upgrade, Front Panel Access Lock
	Data	802.1x compatibility, IPSec, TLS/SSL, Secure File Erase, Secure Disk Erase, SNMP v3, Certificates Management, NTLM v2	802.1x compatibility, IPSec, TLS/SSL, self-encrypted HD, Secure File Erase, Secure Disk Erase, SNMP v3, Certificates Management, NTLM v2
	Document	N/A	PIN printing, API Netgarden compatibility

HP DesignJet T-series: High-impact Accuracy



HP DesignJet T2530 Multifunction Printer Series

HP DesignJet T1530/930 Printer Series

HP DesignJet T1700 Printer Series

914 mm (36 inch)/A0	914 mm (36 inch)/A0	1118 mm (44 inch)/B0+
Yes	No	No
Yes	Yes	Yes
21 sec/page on A1, 120 A1 prints/hour	21 sec/page on A1, 120 A1 prints/hour	26 sec/page on A1/D, 116 A1/D prints/hour
Color: up to 6.35 cm/sec, (2.5 in/sec). Grayscale: up to 19.05 cm/sec (7.5 in/sec)	No	No
Basic multifunction printer: HP-GL/2, HP-RTL, TIFF, JPEG, CALS G4, URF	Basic printer: HP-GL/2, HP-RTL, TIFF, JPEG, CALS G4, URF	Basic Printer: HP-GL/2, TIFF, JPEG, URF, CALS G4
PostScript® multifunction printer: Adobe PostScript® 3, Adobe PDF 1.7 Extension Level 3, HP-GL/2, HP-RTL, TIFF, JPEG, CALS G4, URF	PostScript® printer: Adobe PostScript® 3, Adobe PDF 1.7 Extension Level 3, HP-GL/2, HP-RTL, TIFF, JPEG, CALS G4, URF	PostScript® Printer: Adobe PostScript® 3, Adobe PDF 1.7 ext 3, HP-GL/2, TIFF, JPEG, URF, CALS G4
TIFF, JPEG	No	No
PDF	No	No
130- and 300-ml Original HP Ink cartridges	130- and 300-ml Original HP Ink cartridges	130- and 300-ml Original HP Ink cartridges
Bright Office Ink	Bright Office Ink	Bright Office Ink
Two automatic front-loading roll feeds; rolls up to 91.4-m (300-ft) long	T1530: Two automatic front-loading roll feeds; rolls up to 91.4-m (300-ft) long / T930: One automatic front-loading roll feed; rolls up to 91.4-m (300-ft) long	T1700: One automatic roll feed; rolls up to 91.4-m (300-ft) long / T1700dr: Two automatic roll feeds; rolls up to 91.4-m (300-ft) long
2 inch; 3 inch only with optional accessory	2 inch; 3 inch only with optional accessory	2 inch; 3 inch only with optional accessory
Yes	Yes	Yes
Integrated output stacker, up to 50 A1/D-size capacity and integrated media bin	Integrated output stacker, up to 50 A1/D-size capacity and integrated media bin	Integrated media bin
128 GB (file processing, based on 1.5 GB RAM), 500 GB hard disk	96 GB (file processing, based on 1.5 GB RAM), 500 GB hard disk	128 GB (based on 4 GB DDR3 RAM) virtual 500 GB SED hard disk
Gigabit Ethernet (1000Base-T), Hi-Speed USB 2.0 certified host connector	Gigabit Ethernet (1000Base-T), Hi-Speed USB 2.0 certified host connector	Ethernet, Fast Ethernet, Gigabit Ethernet, 10/100/1000Base-T Ethernet (802.3, 802.3u, 802.3ab); USB Type-A host port
Yes	Yes	Yes
Yes	Yes	Yes
Yes	Yes	Yes
Yes	Yes	Yes
Yes	Yes	Yes
Yes	Yes	Yes
No	No	No
Yes	Yes	Yes
UEFI Secure Boot, disable network ports and protocols, signed firmware upgrade, Front Panel Access Lock	UEFI Secure Boot, disable network ports and protocols, signed firmware upgrade, Front Panel Access Lock	HP Secure Boot, whitelisting, disable network ports and protocols, HP Signed firmware upgrade, Role Based Access Control, Front Panel Access Lock
802.1x compatibility, IPSec, TLS/SSL, Secure File Erase, Secure Disk Erase, SNMP v3, Certificates Management, NTLM v2	802.1x compatibility, IPSec, TLS/SSL, self-encrypted HD (optional), Secure File Erase, Secure Disk Erase, SNMP v3, Certificates Management	802.1x compatibility, IPSec, TLS/SSL, self-encrypted HD, SNMP v3, embedded FIPS 140 (for US only), Secure File Erase, Secure Disk Erase
PIN printing	PIN printing, aPI Netgard compatibility, integrated pull printing solution	Integrated pull-printing solution with Celiveo, PIN printing

Specifications to
Help You Choose



HP DesignJet T830 Multifunction Printer

Printer size/paper size			610 mm (24 inch) and 914 mm (36 inch)/A1 and A0
Scan and copy functions			Yes
PostScript® version available			No
Print speed (line drawings)			24-in: 26 sec/page on A1, 81 A1 prints/hour / 36-in: 25 sec/page on A1, 82 A1 prints/hour
Scan speed			Color: up to 3.81 cm/sec (1.5 in/sec) Grayscale: up to 11.43 cm/sec (4.5 in/sec)
Print languages (standard)			TIFF, JPEG, CALS G4, HP-GL/2, HP-RTL, URF
Additional print languages PostScript® SKU/PostScript® upgrade (optional)			No
Scan formats (standard)			JPEG, TIFF, PDF
Additional scan formats PostScript® upgrade (optional)			No
Ink cartridges capacity			69- and 300-ml matte black ; 40-, 130-, and 300-ml yellow, magenta, and cyan Original HP Ink cartridges
Number of rolls/maximum roll length			One roll feed; rolls up to 45.7-m (150-ft) long
Compatible media core size			2 inch
Cut sheet support			Yes
Media handling: output, capacity			Integrated media bin
Memory			1 GB
Interfaces (standard)			Gigabit Ethernet (1000Base-T), Wi-Fi
PIN printing			No
Mobile printing	Email printing		Yes
	In-OS printing		Yes
	HP Smart App		Yes
Job accounting functionality			No
Manage print queues			No
HP SmartStream for HP DesignJet printers			No
HP DesignJet Partner Link Alert Service			No
Security	Device		Disable network ports Protocols
	Data		Certificates Management, TLS/SSL, 802.1x compatibility, NTLM

HP DesignJet T-series: High-impact Accuracy



HP DesignJet T730 Printer



HP DesignJet T520 Printer Series



HP DesignJet T120 Printer

914 mm (36 inch)/A0	610 mm (24 inch) and 914 mm (36 inch)/A1 and A0	610 mm (24 inch)/A1
No	No	No
No	No	No
25 sec/page on A1, 82 A1 prints/hour	35 sec/page on A1, 70 A1 prints/hour	45 sec/page on A1, 60 A1 prints/hour
No	No	No
HP-GL/2, HP-RTL, TIFF, JPEG, CALS G4, URF	HP-GL/2, HP-RTL, JPEG, CALS G4	JPEG
No	No	No
No	No	No
No	No	No
69- and 300-ml matte black; 40-, 130-, and 300-ml yellow, magenta, and cyan Original HP Ink cartridges	38- and 80-ml black; 29-ml individual and 3 packs (all other colors) Original HP Ink cartridges	38- and 80-ml black; 29-ml individual and 3 packs (all other colors) Original HP Ink cartridges
One roll feed; rolls up to 45.7-m (150-ft) long	One roll feed; rolls up to 45.7-m (150-ft) long	One roll feed; rolls up to 45.7-m (150-ft) long
2 inch	2 inch	2 inch
Yes	Yes	Yes
Integrated media bin	Integrated media bin	Optional media bin
1 GB	1 GB	256 MB
Gigabit Ethernet (1000Base-T), Wi-Fi	Fast Ethernet (100Base-T), Hi-Speed USB 2.0 certified, Wi-Fi	Fast Ethernet (100Base-T), Hi-Speed USB 2.0 certified, Wi-Fi
No	No	No
Yes	Yes	Yes
Yes	Yes	Yes
Yes	Yes	Yes
No	No	No
No	No	No
No	No	No
No	No	No
Disable network ports Protocols	Disable network ports Protocols	Disable network ports Protocols
Certificates Management, TLS/SSL, 802.1x compatibility	N/A	N/A

Making an Impact on Growth





You have big goals and dreams for your business.

HP DesignJet large-format printers are uniquely able to help you achieve them. These remarkable devices represent a major leap forward in large-format printers and include some of the world's most sophisticated printer technology and features.

HP DesignJet printers will help you operate more efficiently, increase productivity, and reduce costs—all while meeting the highest standards of print quality. In short, they'll help elevate your business to new heights of prosperity. No wonder businesses eager to grow are selecting HP DesignJet.

There's more to learn about these powerful printers—much more. For details, visit hp.com/go/designjet





RPG Squarefoot Solutions

(800) 521-6319

www.rpg.com

info@rpg.com

Brochure | HP DesignJet

1. Embedded in some HP DesignJet printers is an i1 spectrophotometer from X-Rite. Close collaboration between HP and X-Rite ensures a reliable solution that's been thoroughly tested to meet customer demands for ease, quality, and dependability.
2. Vertical trimmer and dual rolls included with the HP DesignJet Z9"dr 44-in PostScript® Printer with V-Trimmer only. Up to 20% reduction in post-processing labor time based on internal HP testing compared to HP DesignJet Z9"dr series printers without built-in vertical trimmer.
3. EPEAT® registered where applicable. EPEAT registration varies by country. See <http://www.epeat.net> for registration status by country.
4. Once image is selected, one-click printing when printing the entire file without any modifications to the print settings. Applicable to PDF, JPEG, TIFF, and HP-GL/2 files.
5. Local printing requires mobile device and printer to be on the same network (usually Wi-Fi access points bridge wireless to wired connections) or have a direct wireless connection. Wireless performance is dependent on physical environment and distance from access point. Wireless operations are compatible with 2.4 GHz operations only. Remote printing requires an Internet connection to an HP web-connected printer. Wireless broadband use requires separately purchased service contract for mobile devices. Check with service provider for coverage and availability in your area. See hp.com/go/designjetmobility for more details.
6. The HP Smart App is available for Apple® iPad, iPhone, and iPod Touch running iOS v7.0 or later and for Android™ mobile devices running Android™ v4.4 or later. The HP Smart App is available for free from the Apple® App Store for Apple® mobile devices and from the Google Play Store for Android™ mobile devices.
7. Requires an HP Applications Center account, Internet connection, and connected Internet-capable device. For more information, see <http://www.hpapplicationscenter.com>.
8. Compared with large-format photo inks inkjet printers under \$25,000 USD for graphics applications. Based on the fastest-rated color speeds as published by manufacturers as of June, 2017. Test methods vary.
9. Compared with large-format inkjet printers under \$25,000 USD for graphics applications. Based on the fastest-rated color speeds as published by manufacturers as of June, 2017. Test methods vary.

Adobe and Adobe PostScript 3 are trademarks of Adobe Systems Incorporated.
ENERGY STAR and the ENERGY STAR mark are registered trademarks owned by the U.S. Environmental Protection Agency.
PANTONE is the property of Pantone, Inc.

© Copyright 2017, 2018 HP Development Company, L.P. The information contained herein is subject to change without notice. The only warranties for HP products and services are set forth in the express warranty statements accompanying such products and services. Nothing herein should be construed as constituting an additional warranty. HP shall not be liable for technical or editorial errors or omissions contained herein.

4AA4-5696EEP, June 2018